

-OWNERS MANUAL-

PATHFINDER

SNOWPLOWS

TRUCK SNOWPLOWS

TRACTOR FRONT BLADES

45 INDUSTRIAL DR.

EXETER, R.I. 02822-2001

401-397-4700

EMAIL: pathfindersnowplows@gmail.com

WEBSITE: www.pathfindersnowplows.com

FOR MOLDBOARD TRIP AND TRIP EDGE SNOWPLOWS

MODEL H SNOWPLOWS PRODUCTION BEGINNING IN 2016-

DATE PURCHASED _____

DEALER: PLEASE TRANSMIT THIS BOOKLET TO PURCHASER

WARRANTY REGISTRATION FORM ENCLOSED

(see other side for warranty information)

NO WARRANTY EXISTS FOR CORRODED ELECTRICAL PARTS-USE DIELECTRIC GREASE.

PATHFINDER SNOWPLOW WARRANTY

MODEL SNOWPLOWS PRODUCED BEGINNING IN

Pathfinder Snowplows warrants to the original purchaser of a PATHFINDER® Snowplow that it be free of defects in material and workmanship under normal use and service. The obligation of the Company under this warranty is limited, after delivery to the original purchaser, to repairing or replacing as the Company may elect, any parts that prove, in the Company's judgement, to be defective in material or workmanship within ONE year for the snowplow components and one year for the hydraulic system.

This warranty shall not apply (1) to normal maintenance services or adjustments, (2) to any snowplows that have been operated in a manner not recommended in the operating instructions accompanying the blade, or any blade package that has been repaired, altered, neglected, abused, or used in any way which in the Company's opinion, adversely affects its use. Parts subject to extreme wear are not warranted against wear, and are expected by the Company to be replaced by the purchaser when such parts are worn out or clearances become excessive due to normal wear.

This warranty and the Company's obligation thereunder is in lieu of all warranties, expressed or implied, including without limitation, the implied warranties or merchantability and fitness for particular purpose, all other representations to the original purchaser and all other obligations or liabilities, including liability for incidental and consequential damages on the part of the Company or the seller with respect to the sale or use of the item warranted.

No other person is authorized to give any other warranties or to assume any other liability on the Company's behalf unless made in writing by the Company. No dealer is authorized to make any repair or replace any parts at the expense of the Company without specific authorization from the Company. Specific authorization may be obtained by telephone and will consist of a digital sequence.

THIS WARRANTY APPLIES ONLY TO SNOWPLOWS FOR WHICH THE WARRANTY REGISTRATION FORM HAS BEEN RECEIVED BY THE MANUFACTURER WITHIN 15 DAYS OF THE PURCHASE OF THE BLADE.

WARRANTY REGISTRATION FORM

Purchaser's name _____ Date _____

Purchaser's Address _____

Dealer's Address _____ Phone _____

Blade Size _____ Model _____

Tractor Used On: Make _____ Model _____ Year _____

Truck Used On:

Make _____ Model _____ Year _____

MAIL TO: Pathfinder Snowplows, 45 Industrial Dr., Exeter, R.I. 02822

YOUR NEW SNOWPLOW

Your new Pathfinder Snowplow has been designed, engineered, and thoroughly tested to provide you with a highly efficient, durable, and dependable instrument for snow removal. When used properly, you can expect many years of use from it, even under the most severe winter weather.

Snowplowing with a storm seldom is a problem. Snow moves easily when not allowed to build up heavy deposits. Obstructions hidden by snow present potential problems. Always know the surface you are plowing. Inspect it before any snowfall. Should you strike any objects with the snowplow, a limited, built-in safety feature will be activated.

On RD – Models, when plowing rough surfaces the plow will trip forward to ride over these surfaces. The extension coil springs on the plow will return the moldboard to its upright position. On the TE- Models, when plowing rough terrain the cutting edge trips – this enables the plow to contact more of the surface being plowed. The cutting edge is attached with a custom formulated poly spring. This polyurethane reacts faster than coil springs systems and reduces impact shock to the plow. Heavy impacts over 15 mph may exceed the ability of safety features to absorb shock generated. Reasonable use of the snowplow will result in satisfactory performance.

Careful reading of all the accompanying literature in the snowplow package – Owner's manual, Installation manual, Parts sheets, and warranty, will familiarize you with the knowledge you will need to know.

Any questions feel free to email us at: pathfindersnowplows@gmail.com

Or call us at: 401-397-4700

REMOVING SNOWPLOW FROM VEHICLE

1. PARK VEHICLE ON LEVEL TERRAIN AND SHIFT INTO NEUTRAL
2. HOLD DOWN SWITCH ON REMOTE TO ACTIVATE FLOAT (RED LIGHT ON).
USING YOUR HAND, FORCE THE LIFT ARM ALL THE WAY DOWN, SLACKING
THE LIFT CHAIN.
3. DISCONNECT LIFT CHAIN
4. PIN CRANK JACK INSIDE A-FRAME, CRANK TO RELEASE PRESSURE OFF
MOUNTING PINS
5. DISCONNECT ALL ELECTRICALS.
6. REMOVE PINS (G).
7. REMOVE PINS (F).
8. BACK THE VEHICLE AWAY FROM THE PLOW.
9. REVERSE THIS PROCESS TO ATTCH THE PLOW TO THE VEHICLE.

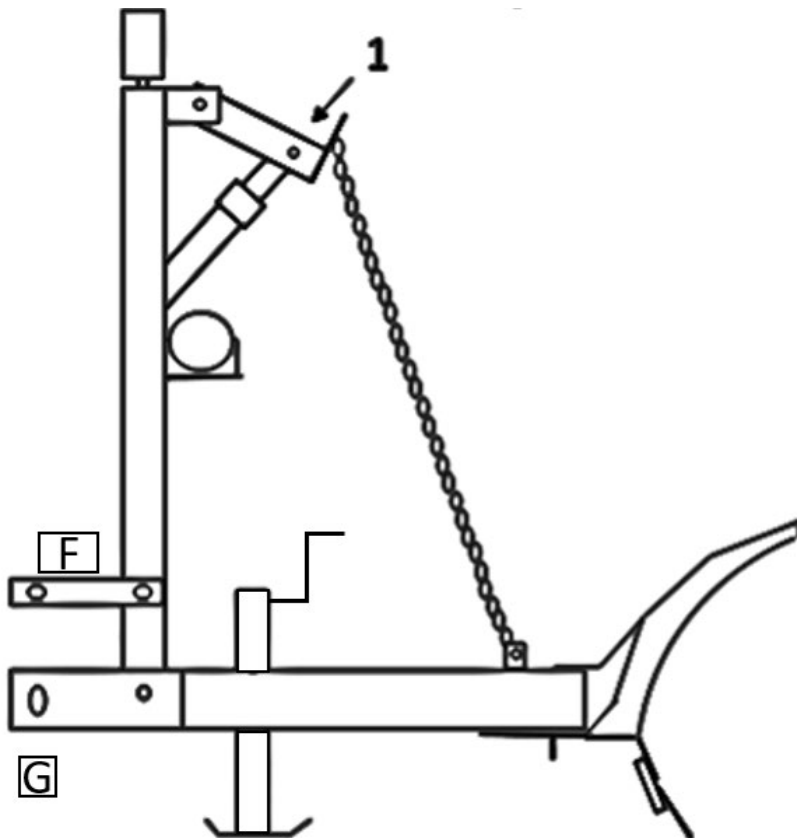

	A FRAME	LIFT FRAME	POWER UNIT	GROUP	PARTS	LISTING	MODEL
REF.	P/N	QUAN.	DESCRIPTION (USE IN ORDERING)				
1	F1	1	LIFT FRAME				
2	F2	1	LIFT FRAME MAIN PIN				
3	F3	1	POWER UNIT SHELF				
4	F4	1	A FRAME MODEL RD				
4	F4A	1	A FRAME MODEL TE				
5	F5	1	LIFT ARM				
6	F6	1	LIFT CYLINDER				
7	F7	2	POWER ANGLE CYLINDERS				
8	F8	2	POWER ANGLE CYLINDER HOSE 4'				
9	F9	1	LIFT CYLINDER HOSE 2'				
9	F9A	1	LIFT CYLINDER 45 FITTING				
10	F10	1	LIFT ARM TO LIFT FRAME PIN 3/4 X 6 W/ COTTERS				
11	F11	2	HEAD LIGHTS				
12	F12	1	HEAD LIGHT HARNESS				
13	F13	1	3/4 X 4 LIFT ARM PIN W/ COTTER				
14	F14	1	P. A. CYLINDER PINS W/ COTTERS 1X6				
15	F15	1	SWIVEL PIN W/ COTTER 1X6				
16	F16	1	POWER UNIT HARNESS PLUG				
17	F17	2	5/16 LINCH PINS				
18	F18	1	JACK STAND PIN				
19	F19	2	MOUNTING PINS				
20	F20	2	P. A. CYLINDERS PINS 1X4				
21	F21	1	LIFT CYLINDER BASE PIN 1 X 4				
22	F22	2	LIFT FRAME BASE PIN 5/8 X 2.25				
23	F23	1	POWER UNIT END CAP				
25	F25	1	LIFT CHAIN BOLT GRADE 8, 7/16 X 2 1/2				
26	F26	1	LIFT CHAIN				
29	F29	4	3/8 X 1 BOLT, NUT, FLAT WASHERS, LOCK WASHER				
30	F30	1	POWER UNIT				
31	F31	1	POWER UNIT CAP				
32	F32	3	1/4 X 90 SWIVEL ADAPTER UNIONS				
33	F33	1	TOGGLE SWITCH				
34	F34	1	TOGGLE SWITCH WEATHERPROOF BAT BOOT				
35	F35	1	POWER CABLE ASSEMBLY - PLOW HALF				
36	F36	1	POWER UNIT HARNESS - PLOW HALF				
37	F37	1	POWER UNIT HARNESS - VEHICLE HALF				
38	F38	1	CAB CONTROL STATION HARNESS				
39	F39	1	JOY STICK CONTROL ASSEMBLY				
40	F40	1	ROCKER SWITCH CONTROL ASSEMBLY				
41	F41	1	GROUND CABLE				
42	F42	1	POWER CABLE - VEHICLE HALF				
43	F43	1	MOTOR SOLENOID				
44	F44	1	POWER CABLE-BATTERY TO SOLENOID				
45	F45	2	3/16 LINCH PINS				
46	F46	2	HITCH PIN CLIPS				
47	F47	1	JACK STAND MOUNT W/ BOLTS				
48	F48	1	JACK STAND				
49	F49	2	LIFT FRAME TO RACK PINS 7/8 X 5 1/2				

LIFT FRAME, POWER UNIT, JACK STAND ASSEMBLY

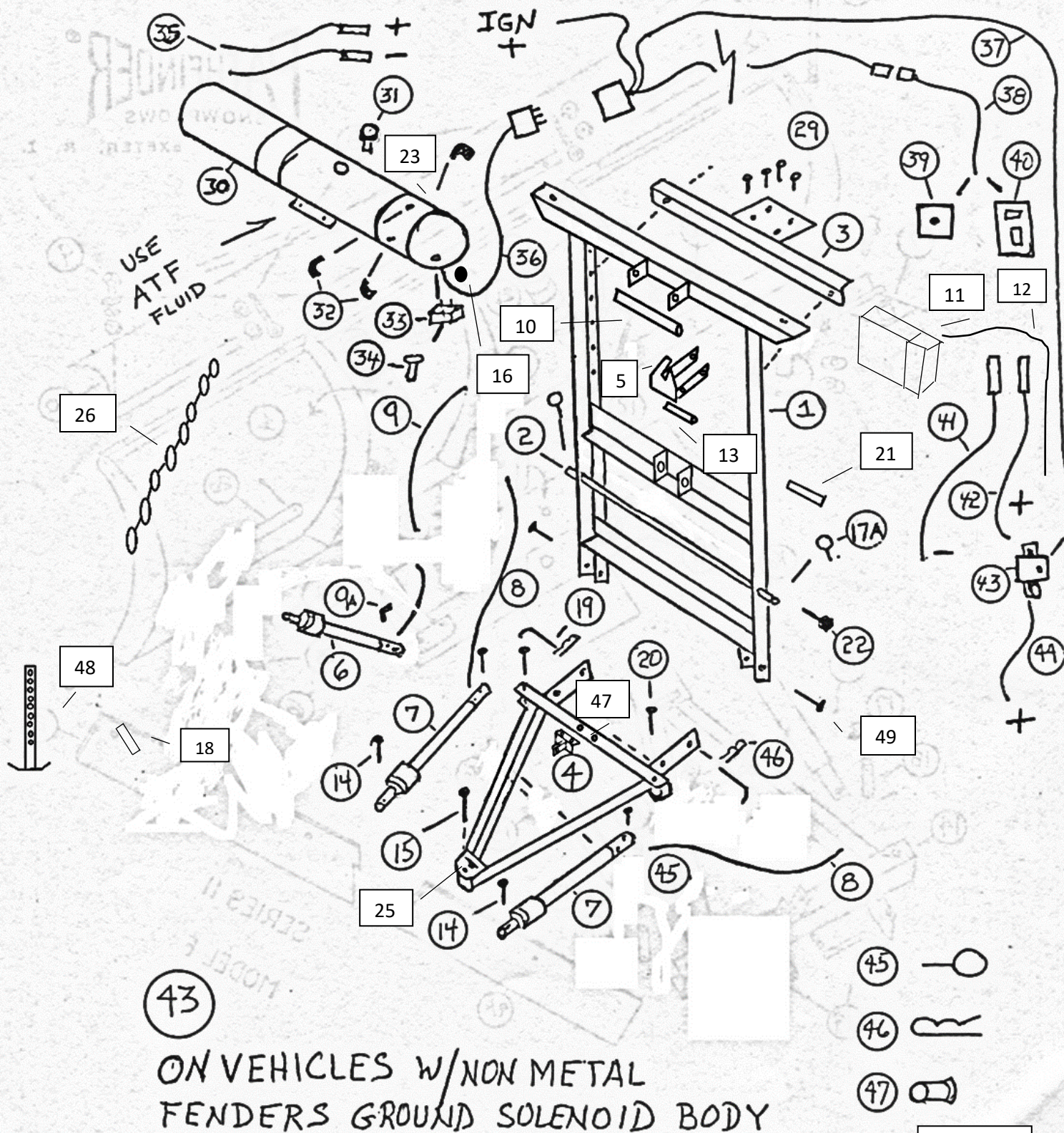

RH

4/15

	A FRAME	LIFT FRAME	POWER UNIT	GROUP	PARTS	LISTING	MODEL
REF.	P/N	QUAN.	DESCRIPTION (USE IN ORDERING)				
1	F1	1	LIFT FRAME				
2	F2	1	LIFT FRAME MAIN PIN				
3	F3	1	POWER UNIT SHELF				
4	F4	1	A FRAME MODEL RD				
4	F4A	1	A FRAME MODEL TE				
5	F5	1	LIFT ARM				
6	F6	1	LIFT CYLINDER				
7	F7	2	POWER ANGLE CYLINDERS				
8	F8	2	POWER ANGLE CYLINDER HOSE 4'				
9	F9	1	LIFT CYLINDER HOSE 2'				
9	F9A	1	LIFT CYLINDER 45 FITTING				
10	F10	1	LIFT ARM TO LIFT FRAME PIN 3/4 X 6 W/ COTTERS				
11	F11	2	HEAD LIGHTS				
12	F12	1	HEAD LIGHT HARNESS				
13	F13	1	3/4 X 4 LIFT ARM PIN W/ COTTER				
14	F14	1	P. A. CYLINDER PINS W/ COTTERS 1X6				
15	F15	1	SWIVEL PIN W/ COTTER 1X6				
16	F16	1	POWER UNIT HARNESS PLUG				
17	F17	2	5/16 LINCH PINS				
18	F18	1	JACK STAND PIN				
19	F19	2	MOUNTING PINS				
20	F20	2	P. A. CYLINDERS PINS 1X4				
21	F21	1	LIFT CYLINDER BASE PIN 1 X 4				
22	F22	2	LIFT FRAME BASE PIN 5/8 X 2.25				
23	F23	1	POWER UNIT END CAP				
25	F25	1	LIFT CHAIN BOLT GRADE 8, 7/16 X 2 1/2				
26	F26	1	LIFT CHAIN				
29	F29	4	3/8 X 1 BOLT, NUT, FLAT WASHERS, LOCK WASHER				
30	F30	1	POWER UNIT				
31	F31	1	POWER UNIT CAP				
32	F32	3	1/4 X 90 SWIVEL ADAPTER UNIONS				
33	F33	1	TOGGLE SWITCH				
34	F34	1	TOGGLE SWITCH WEATHERPROOF BAT BOOT				
35	F35	1	POWER CABLE ASSEMBLY - PLOW HALF				
36	F36	1	POWER UNIT HARNESS - PLOW HALF				
37	F37	1	POWER UNIT HARNESS - VEHICLE HALF				
38	F38	1	CAB CONTROL STATION HARNESS				
39	F39	1	JOY STICK CONTROL ASSEMBLY				
40	F40	1	ROCKER SWITCH CONTROL ASSEMBLY				
41	F41	1	GROUND CABLE				
42	F42	1	POWER CABLE - VEHICLE HALF				
43	F43	1	MOTOR SOLENOID				
44	F44	1	POWER CABLE-BATTERY TO SOLENOID				
45	F45	2	3/16 LINCH PINS				
46	F46	2	HITCH PIN CLIPS				
47	F47	1	JACK STAND MOUNT W/ BOLTS				
48	F48	1	JACK STAND				
49	F49	2	LIFT FRAME TO RACK PINS 7/8 X 5 1/2				

REGULAR DUTY MODEL F 1997-

BLADE ASSEMBLY

PATHFINDER[®]
SNOWPLOWS

EXETER, R. I.

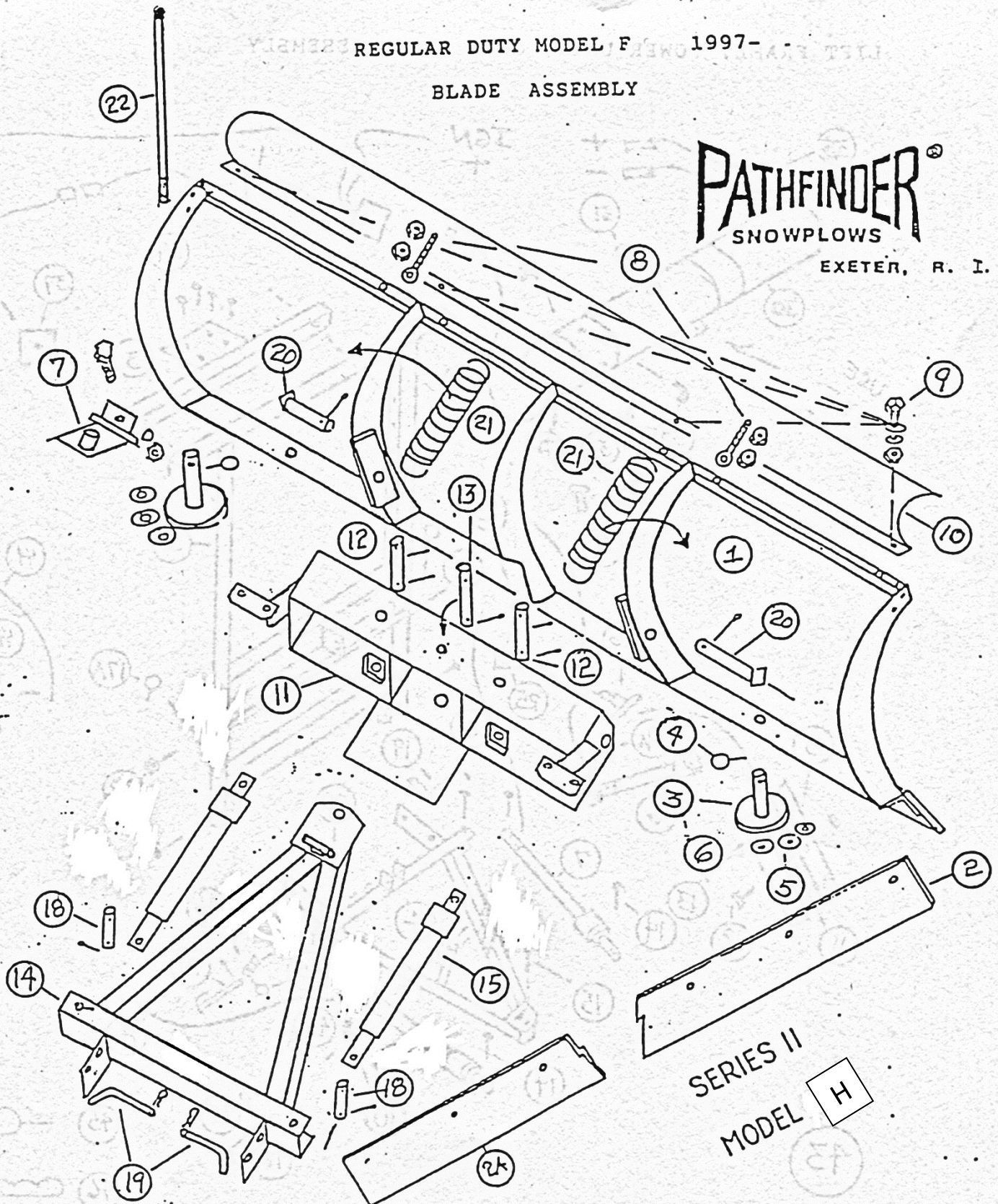

SERIES II

MODEL **H**

PATHFINDER SNOWPLOWS : 45 INDUSTRIAL DRIVE EXETER, R. I. 02822

PATHFINDER®

FRONT CONTROL STATION

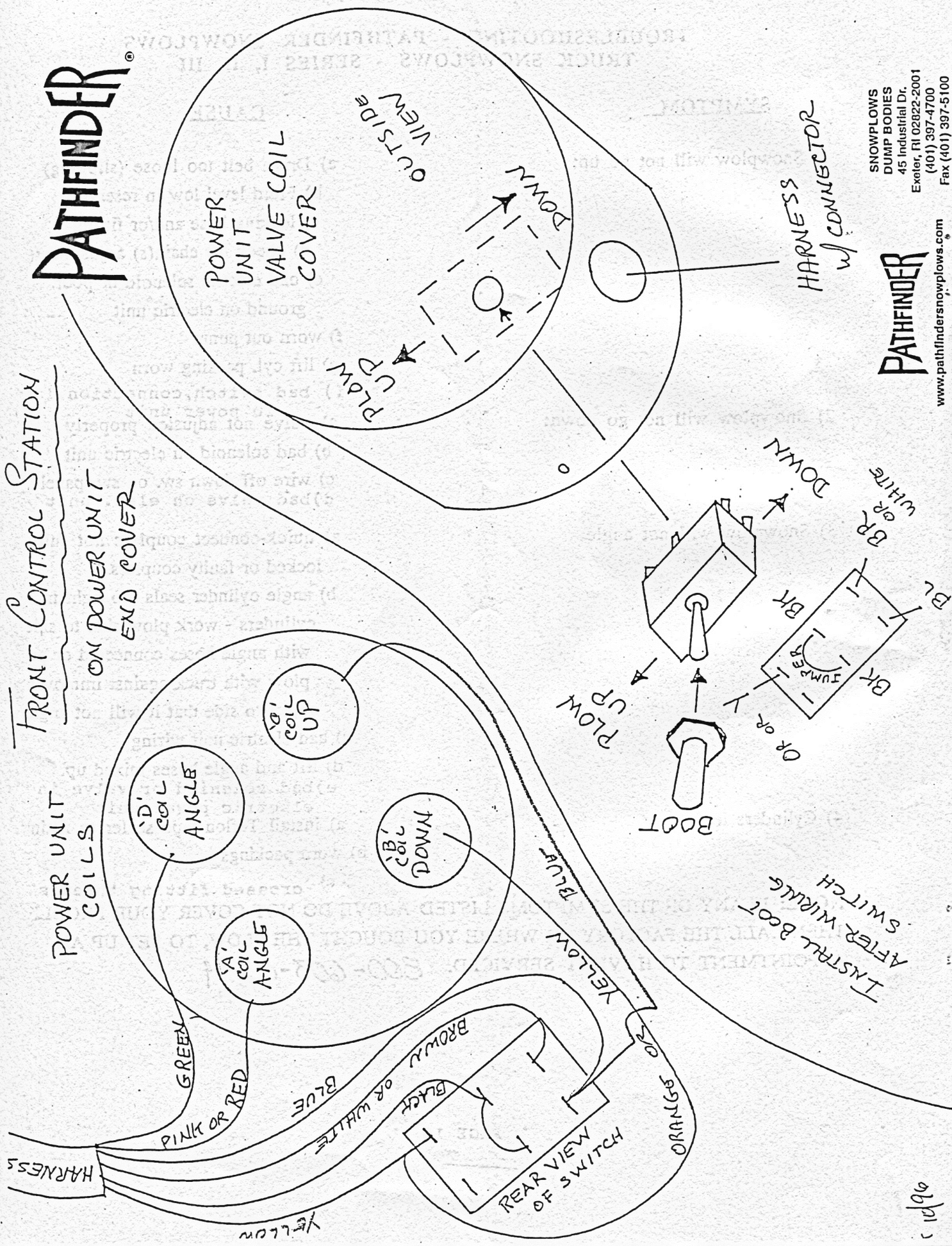

SNOWPLOW
DUMP BODIES
45 Industrial Dr.
Exeter, RI 02822-2001
(401) 397-4700
Fax (401) 397-5100

PATHFINDER

www.pathfindersnowpows.com

10/96

DRILLING 5/8 X 2 FLAT PLATE LINKS

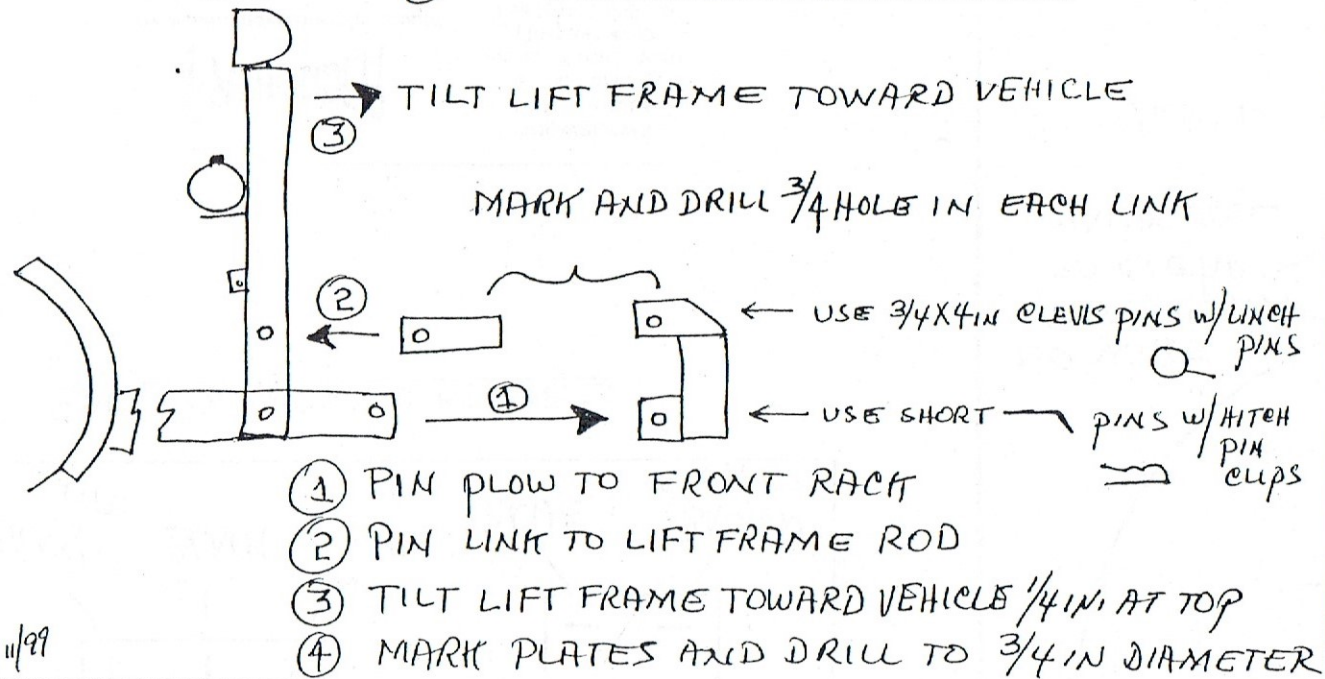

FT 11/99

BLACK AND BROWN WIRES
EXTENDING FROM RECEPTACLE
OF TRUCK HARNESS

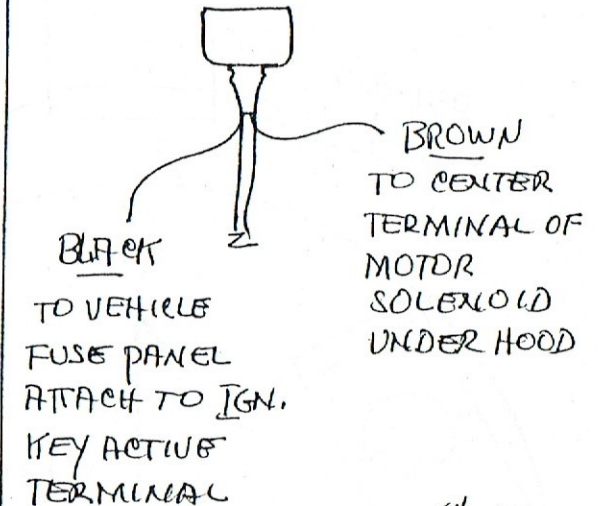

FT 11/99

INSTALLATION OF 3 POSITION SWITCH FOR PLOW HEADLAMPS

(TO AVOID NEED FOR COMPOSITE HEADLAMP ADAPTERS AND ENTERING THE VEHICLE
WIRING HARNESSES WITH OR WITHOUT DAYLIGHT RUNNING LIGHTS)

BLACK AND RED WIRES IN THE PLOW LAMP
HARNESS ARE HIGH AND LOW BEAM. ALL
OTHERS ARE NOT USED - TAPE OFF.

USE 30 AMP+
AVAILABLE SPOT

VEHICLE FUSE
PANEL

TO
LOW BEAM

SIDE
VIEW

TO
HIGH BEAM

FUSE

STAPLE
YELLOW AND
BLUE WIRES TO
TRUCK PARK
AND SIGNAL
WIRES.

PATHFINDER

www.pathfindersnowplows.com

SNOWPLOWS
DUMP BODIES
45 Industrial Dr.
Exeter, RI 02822-2001
(401) 397-4700
Fax (401) 397-5100

FT 11/99

To Fill Power Unit Fluid in Pathfinder Snowplow

1. Fill the power unit with only new dexron/mercon automatic transmission fluid to horizontal bar in reservoir tank.
2. Angle the blade left once.
3. Fill reservoir tank to bar.
4. Angle blade right once.
5. Fill reservoir tank to bar.
6. Lift and drop plow two to three times.
7. Check fluid level with lift cylinder fully collapsed (hold switch down on power unit end cap while simultaneously forcing lift arm down). Fluid should be level with horizontal bar in tank.